

RELEASABLE FITTINGS

Straight stud couplings

D	A	Item nr.
M10 x 1,5	6 x 1	VSC1124 9512
M12 x 1,5	6 x 1	VSC1125 9512
M14 x 1,5	6 x 1	VSC1126 9512
M16 x 1,5	6 x 1	VSC1123 9512
M22 x 1,5	6 x 1	VSC1127 9512
M10 x 1	8 x 1	VSC1129 9512
M12 x 1,5	8 x 1	VSC1130 9512
M14 x 1,5	8 x 1	VSC1132 9512
M16 x 1,5	8 x 1	VSC1128 9512
M22 x 1,5	8 x 1	VSC1131 9512
M12 x 1,5	10 x 1	VSC1135 9512
M16 x 1,5	10 x 1	VSC1133 9512
M22 x 1,5	10 x 1	VSC1138 9512
M12 x 1,5	12 x 1,5	VSC1141 9512
M14 x 1,5	12 x 1,5	VSC1143 9512
M16 x 1,5	12 x 1,5	VSC1140 9512
M22 x 1,5	12 x 1,5	VSC1142 9512
M16 x 1,5	15 x 1,5	VSC1145 9512
M22 x 1,5	15 x 1,5	VSC1147 9512
M16 x 1,5	16 x 2	VSC1148 9512
M22 x 1,5	16 x 2	VSC1150 9512
M22 x 1,5	18 x 2	VSC1151 9512

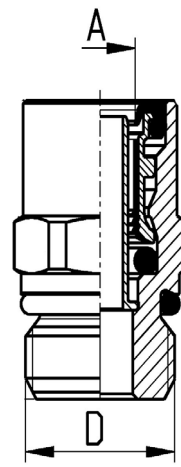

Straight connectors

A	Item nr.
6 x 1	VSC1163 9580
8 x 1	VSC1164 9580
10 x 1	VSC1165 9580
12 x 1,5	VSC1168 9580
15 x 1,5	VSC1171 9580
16 x 2	VSC1172 9580
18 x 2	VSC1173 9580

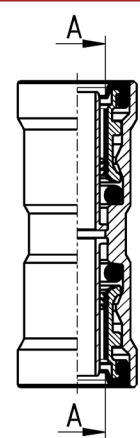

Branch tee couplings

D	A	Item nr.
M16 x 1,5	6 x 1	VSC1054 9412
M12 x 1,5	6 x 1	VSC1056 9412
M22 x 1,5	6 x 1	VSC1057 9412
M16 x 1,5	8 x 1	VSC1058 9412
M12 x 1,5	8 x 1	VSC1059 9412
M22 x 1,5	8 x 1	VSC1060 9412
M16 x 1,5	10 x 1	VSC1062 9412
M12 x 1,5	10 x 1	VSC1064 9412
M22 x 1,5	10 x 1	VSC1066 9412
M16 x 1,5	12 x 1,5	VSC1067 9412
M22 x 1,5	12 x 1,5	VSC1069 9412
M16 x 1,5	15 x 1,5	VSC1070 9412
M22 x 1,5	15 x 1,5	VSC1072 9412

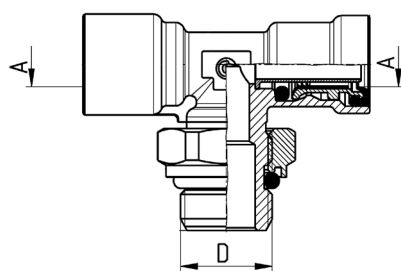

T screw-in sockets

M1	M2	Item nr.
M16 x 1,5	M12 x 1,5	810 1215 5.
M16 x 1,5	M16 x 1,5	810 1615 5.
M16 x 1,5	M22 x 1,5	VSC1014 D2062
M16 x 1,5	M22 x 1,5	810 2215 5.

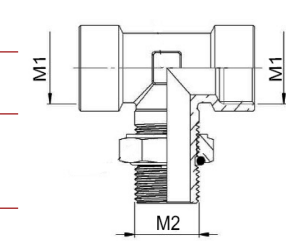

Barrel tee couplings

D	A	Item nr.
M16 x 1,5	6 x 1	VSC1074 9422
M10 x 1	6 x 1	VSC1075 9422
M12 x 1,5	6 x 1	VSC1076 9422
M16 x 1,5	8 x 1	VSC1077 9422
M12 x 1,5	8 x 1	VSC1078 9422
M22 x 1,5	8 x 1	VSC1079 9422
M16 x 1,5	10 x 1	VSC1080 9422
M22 x 1,5	10 x 1	VSC1081 9422
M16 x 1,5	12 x 1,5	VSC1082 9422
M22 x 1,5	12 x 1,5	VSC1084 9422
M16 x 1,5	15 x 1,5	VSC1085 9422
M22 x 1,5	15 x 1,5	VSC1072 9422

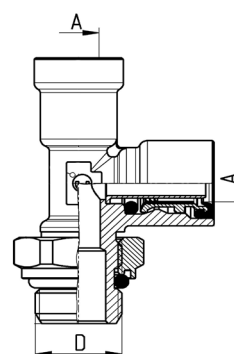

Barrel tees

G1	G2	Item nr.
M12 x 1,5	M12 x 1,5	808 1211 5.
M12 x 1,5	M16 x 1,5	808 1611 5.
M16 x 1,5	M16 x 1,5	808 1615 5.
M16 x 1,5	M22 x 1,5	VSC1018 D2072
M16 x 1,5	M22 x 1,5	808 2215 5.
M22 x 1,5	M22 x 1,5	808 2221 5.

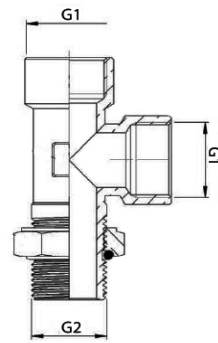

Y screw connections

D	A	Item nr.
M16 x 1,5	8 x 1	VSC1092 9450
M16 x 1,5	12 x 1,5	VSC1093 9450
M22 x 1,5	12 x 1,5	VSC1094 9450

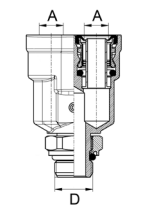

F screw connections

D	A	Item nr.
M16 x 1,5	12 x 1,5	VSC1052 9402
M22 x 1,5	12 x 1,5	VSC1053 9402

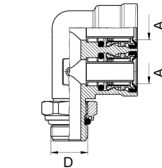

Corner screw-in sockets

D	d	Item nr.
M16 x 1,5	M16 x 1,5	VSC1022 D2077
M22 x 1,5	M16 x 1,5	VSC1023 D2077

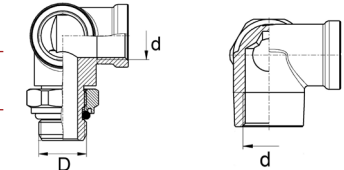

Stud elbow couplings

D	A	Item nr.
M10 x 1,5	6 x 1	VSC1098 9502
M12 x 1,5	6 x 1	VSC1099 9502
M16 x 1,5	6 x 1	VSC1097 9502
M22 x 1,5	6 x 1	VSC1100 9502
M12 x 1,5	8 x 1	VSC1103 9502
M14 x 1,5	8 x 1	VSC1105 9502
M16 x 1,5	8 x 1	VSC1101 9502
M22 x 1,5	8 x 1	VSC1104 9502
M12 x 1,5	10 x 1	VSC1109 9502
M16 x 1,5	10 x 1	VSC1107 9502
M22 x 1,5	10 x 1	VSC1111 9502
M12 x 1,5	12 x 1,5	VSC1114 9502
M16 x 1,5	12 x 1,5	VSC1113 9502
M22 x 1,5	12 x 1,5	VSC1115 9502
M16 x 1,5	15 x 1,5	VSC1117 9502
M22 x 1,5	15 x 1,5	VSC1118 9502
M22 x 1,5	16 x 2	VSC1121 9502
M22 x 1,5	18 x 2	VSC1122 9502

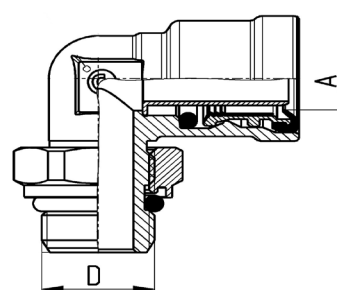

Elbow screw-in sockets

G1	G2	Item nr.
M12 x 1,5	M16 x 1,5	805 1215 5.
M16 x 1,5	M16 x 1,5	805 1615 5.
M16 x 1,5	M22 x 1,5	VSC1008 D2022
M22 x 1,5	M22 x 1,5	805 2221 5.



Cross screws

D	d	Item nr.
M16 x 1,5	M16 x 1,5	VSC1013 D2032
M22 x 1,5	M16 x 1,5	VSC1012 D2032

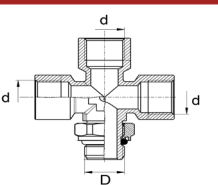

Bulkhead connectors

D	A	B	Item nr.
M16 x 1,5	8	10	VSC1199 9590
M18 x 1,5	12	12	VSC1198 9590

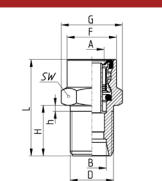

Double connectors

G1	G2	G3	Item nr.
M16 x 1,5	M16 x 1,5	M22 x 1,5	314 9616 5
M16 x 1,5	M22 x 1,5	M22 x 1,5	314 9622 5

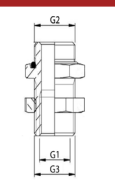

Bulkhead connectors

D	A	B	Item nr.
M18 x 1,5	6 x 1	6 x 1	VSC1202 9592
M18 x 1,5	8 x 1	8/6	VSC1178 9592
M18 x 1,5	12 x 1,5	8 x 1	VSC1179 9592
M24 x 1,5	12 x 1,5	12 x 1,5	VSC1203 9592
M28 x 1,5	15 x 1,5	15 x 1,5	VSC1204 9592

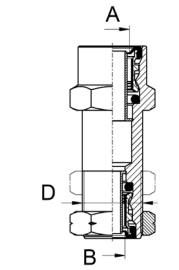

Branch tee couplings

A	A1	Item nr.
6 x 1	6 x 1	VSC1155 9540
8 x 1	8 x 1	VSC1156 9540
10 x 1	10 x 1	VSC1158 9540
12 x 1,5	12 x 1,5	VSC1159 9540

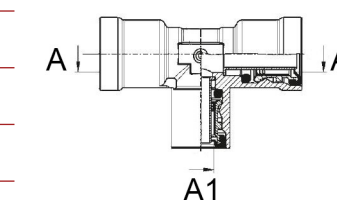

Barrel tee couplings

Thread	Item nr.
M16 x 1,5	308 1615 5.
M22 x 1,5	308 2221 5.



5-fold distributor

d	Item nr.
M16 x 1,5	VSC1190 D3043

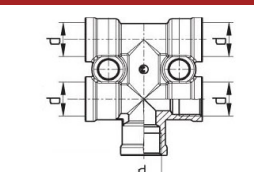

Plug-in units c-truck

B	D	Remark	Item nr.
C1	M16 x 1,5	SW22	VSC1043 D2912
C1	M10 x 1		VSC1045 D2912
C1	M12 x 1,5		VSC1046 D2912
C1	M22 x 1,5		VSC1047 D2912
C1	M14 x 1,5		VSC1049 D2912

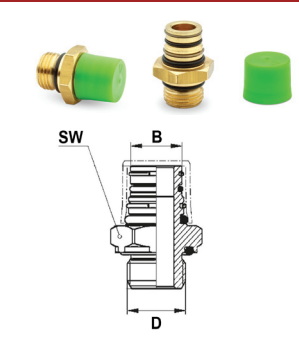

Bulkhead connectors c-truck

B	D	D1	Item nr.
C1	M22 x 1,5	M16 x 1,5	VSC1191 D2993

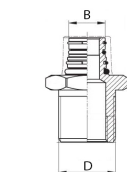

Bulkhead swivel connectors

D	A	B	Item nr.
M20 x 1,5	8 x 1	C1	VSC1200 9919
M24 x 1,5	12 x 1,5	C1	VSC1201 9919

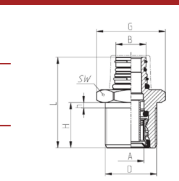

Elbow screw c-truck

d	A	B	Item nr.
M16 x 1,5		C1	VSC1024 D2220
M12 x 1,5		C1	VSC1025 D2220
	6 x 1	C1	VSC1185 9520
	8 x 1	C1	VSC1152 9520
	10 x 1	C1	VSC1184 9520
	12 x 1,5	C1	VSC1153 9520
	15 x 1,5	C1	VSC1154 9520
	16 x 2	C1	VSC1192 9520
M16 x 1,5		C1	VSC1189 D2210

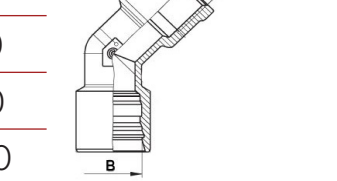
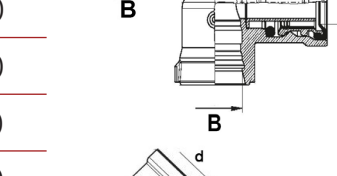
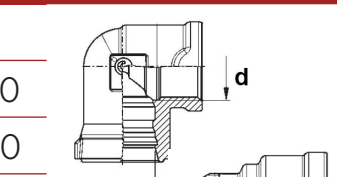

L-piece c-truck

d	A	B	Item nr.
M16 x 1,5		C1	VSC1028 D2270
M12 x 1,5		C1	VSC1029 D2270
	6 x 1	C1	VSC1187 9440
	8 x 1	C1	VSC1089 9440
	10 x 1	C1	VSC1182 9440
	12 x 1,5	C1	VSC1090 9440
	15 x 1,5	C1	VSC1091 9440

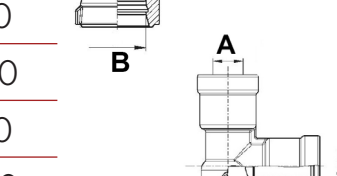
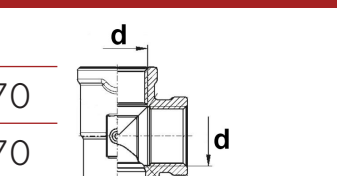

Tee c-truck

d	A	B	Item nr.
M16 x 1,5		C1	VSC1026 D2260
M12 x 1,5		C1	VSC1027 D2260
	6 x 1	C1	VSC1186 9430
	8 x 1	C1	VSC1086 9430
	10 x 1	C1	VSC1183 9430
	12 x 1,5	C1	VSC1087 9430
	15 x 1,5	C1	VSC1088 9430

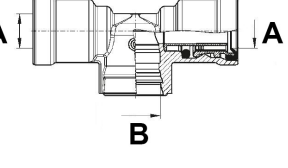
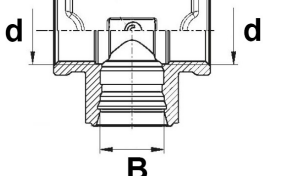

Anti-rotation ring

Remark	Item nr.
SW 22	VSC1180 9707
SW 24	VSC1181 9707



Pipe release tool

Description	Item nr.
Pipe release tool 6	VSC1001 DRK6
Pipe release tool 8	VSC1002 DRK8
Pipe release tool 10	VSC1003 DRK10
Pipe release tool 12	VSC1004 DRK12
Pipe release tool 15	VSC1005 DRK15
Pipe release tool 16	VSC1006 DRK16
Pipe release tool 18	VSC1007 DRK18



Thread adapters (with seal)

||
||
||